



BELDING THEATER

166 Capitol Avenue

Hartford, CT 06106

The Bushnell Box Office:

Phone (860) 987-5900

Administrative Offices:

Phone (860) 987-6000

Fax (860) 987-6070

CONTACT INFORMATION

THEATRICALS / BOOKING

Ric Waldman

V.P. of Programming & Marketing

Phone: (860) 987- 6085

Fax: (860) 987-6070

E-mail: rwaldman@bushnell.org

PROGRAMMING / RENTALS

Tom Sessa

Director, Programs

Phone: (860) 987-6039

Fax: (860) 987-6070

E-mail: tsessa@bushnell.org

Amie Lugo

Programs Assistant

Phone: (860) 987-6056

Fax: (860) 987-6070

E-mail: Alugo@bushnell.org

FRONT OF HOUSE / MERCHANDISE

Kate Pierro

Operations Manager

Phone: (860) 987-6084

Fax: (860) 987-6070

Email: kpierro@bushnell.org

FACILITY SALES & SERVICE

Charlie Meyers

Director of Facility Sales & Service

Phone: (860) 987-6024

Fax: (860) 987-6070

E-mail: cmeyers@bushnell.org

PRODUCTION

Michael J. Sivo

Technical Director

Phone: (860) 987-6063

Fax: (860) 728-0500

Cell: (860) 819-1347

E-mail: msivo@bushnell.org

Sam Burke

Production Coordinator

Phone: (860) 987-6057

Fax: (860) 987-6070

E-mail: sburke@bushnell.org

BOX OFFICE

Margaret Rush

Sr. Manager Box Office

Direct Phone: (860) 987-6050

Fax: (860) 987-6080

E-mail: mrush@bushnell.org

MARKETING & PROMOTION

Beth Hyland

Director of Marketing

Phone: (860) 987-6082

Fax: (860) 987-6070

E-mail: bhyland@bushnell.org

Paul Marte

Communications Manager

Phone: (860) 987-6068

Fax: (860) 987-6070

E-Mail: pmarte@bushnell.org

THE BUSHNELL CENTER FOR THE PERFORMING ARTS

Belding Theater

The interior of the 908-seat Belding Theater is intimate and luxurious, with a decorative painted ceiling, generous use of wood and rich colors and textures. No seat in the theater is more than 75 feet from the stage. Above the orchestra level is a mezzanine that includes private box seating.

THEATER CAPACITY

Total: 908

Orchestra:	617 (deduct 51 seats if orchestra uses Pit)
Accessible/Wheelchair:	6
Sensory Impaired:	6 (Held in the 1 st two center rows)
Companion Seating:	22
Mezzanine:	245 (including 2 Private Boxes, 6 seats each)
Accessible/Wheelchair:	4
Companion Seating:	8

STAGE

Proscenium:	Width 47', height 33'
Deck:	Phenalex (industrial masonite), flat, 2'-11" above orchestra floor. Black in color
Specifications:	Centerline to off stage right wall 46' (not stage left); SR clear fly space 37' Centerline to off stage-left locking rail 42'; SL clear fly space 37' Stage depth 42': taken from proscenium to upstage wall Floor to grid 70' - uniform load of 50lbs per square foot Pipe run 63'-2" Single purchase counterweight system with 75,000lbs available 55 undedicated line-sets, spaced @ 6" o/c, with 6 lines each 2 dedicated motorized line sets for acoustical shell 14' arbors, 2000lb capacity

30 additional sheaves and rope available for single line spotting
 Dual locking rail stage left deck and raised fly-floor @ 33' Pin-rail
 raised stage right @ 33' with upstage crossover to fly-floor. Apron
 edge to proscenium 3'-6"

Pit Elevator: At stage level pit extends 10'-9" at center of crescent-shaped apron
 At auditorium level it will accommodate 51 seats
 At orchestra pit level it will accommodate approx. 40-60 musicians

Travel range is from stage level down 2'-11" to orchestra level, from
 stage level down 9' to pit level, from stage level down 14'-9" to
 basement and trap area

Elevator: 1 backstage, 12' x 10'-10"

Loading Doors: At loading docks 2 @ 8'-4" w x 10' h inside dimension

Stage Door: 8' w x 20' H upstage right corner at loading dock

Loading Docks: (2) Access from Clinton Street (east side) will accommodate 53' trailer

Ramp: There is a ramp that runs parallel to the loading dock for musicians
 who have larger instruments to have direct access to the stage.

Draperies: Front valence and grand drape

7 sets black velour legs (flat)	30'H x 12'W
6 black velour borders (flat)	12'H x 60'W
10 black velour tabs (flat)	30'H x 8'W
2 black velour bi-part traveler	30'H x 60'W
1 Muslin Cyclorama	30'H x 60'W
1 Sharkstooth scrim (black)	30'H x 60'W
1 Sharkstooth scrim (white)	30'H x 60'W

Risers:	24 – 32"x 8'x 8"	4 – 4'x 8'x 8"
	20 – 32"x 8'x 16"	4 – 4' x 8'x 16"

14 – 32"x 8'x 24"

25 – 4'x 8'x 24"

15 – 4' x 8' x 32"

1 each 4'x 4'x (8"),(16"),(24")

Concert Shell: Approximately 1000 square feet, can accommodate approximately 75 musicians

Music Stands/

Chairs: 75 music with clip lights, 100 symphony type chairs
additional folding chairs available.

Pianos: 1 - 9' Steinway D
1 – Yamaha C5SE 6'7"
2 – Yamaha U1SE 48" Upright

STAGEHANDS

IATSE, Local 84

Mike Sullivan Jr, Business Agent

Office: (860) 233-8821, Fax: (860) 233-8827

Minimum call: 3-man crew (Carpenter, Props, Electrician)

4 hours load in, performance, 4 hours load out

LIGHTING

Service: (1) 100 amp 3-phase disconnect located downstage left
(1) 100 amp 3-phase disconnect located downstage right
(2) 400 amp 3-phase disconnect located stage right wall
(1) 400 amp + (1) (200 amp clean) 3-phase disconnect in loading dock area

Circuits:

FOH (all stage pin connectors)

Projection booth (1) 20amp
Far catwalk (12) 20 amp circuits
Near catwalk (12) 20 amp circuits
Far box boom S/L (12) 20 amp circuits + (1) 50 amp circuit
Near box boom S/L (12) 20 amp circuits
Far box boom S/R (12) 20 amp circuits + (1) 50 amp circuit
Near box boom S/R (12) 20 amp circuits
Balcony rail (12) 20 amp circuits + (1) 50 amp circuits

STAGE (all stage pin connectors)

Overhead drops + fixed wall boxes (198) 20 amp circuits + (3) 50 Amp circuits
Trap room (3) 20 amp circuits

FOH Units:

(12) Source Four 10 degree
(48) Source Four 19 degree
(24) Source Four 26 degree

Additional Units Inventory:

(2) Source Four 10 degree
(12) Source Four 19 degree
(38) Source Four 26 degree
(36) Source Four 36 degree
(6) Source Four 50 degree
(48) Par 64 1
(7) Far Cyc 3-circuit

Dimmers: ETC SENSOR- dimmer per circuit (276) 2.4k + (6) 5k dimmers

Light Board: ETC ION 3072 (including Ethernet network to all positions)

Follow-spots: (2) Lycian Super Stars 1200 watt HMI
Concert Lighting: (2) banks each of (5) par 56 units, incorporated in each of two onstage overhead ceilings and 1 ceiling FOH

Contact: Head Electrician, Joe Gates (860) 987-5942

SOUND

The Bushnell Front of House Sound System is in excellent condition including a high quality PA capable of reproducing music clearly and without distortion at 115db at the mixing position and with even coverage throughout the full audience areas.

Main Console: Avid Venue Profile w/ 2-48 channel digital stage boxes

Power Service: (1) 100 amp 3-phase located downstage left
(1) 60 amp breakout located downstage left
(1) 60 amp breakout located downstage right
(1) 100 amp 3-phase located upstage right wall

House PA: Center Cluster D&B 10 AD (x6)
S/R Proscenium: D&B C7 (x3), C7 sub (x1), B2 sub (x1)
S/L Proscenium: D&B C7 (x3), C7 sub (x1), B2 sub (x1)
Front fill: D&B 8S (x4)
Under balcony: (8) EAW JF80T60
Amplifiers: D&B D12 (x7), QSC 1202 (x4)

Monitors: EAW SM200IH (x6)
EAW JF200E (x4)
EAW JF260Z (x2)

EAW RF129Z (x2)

EAW JF80 (x2)

Microphones: Sure SM 58 (x9)
Sure SM 51 (x5)
Sure BETA SM 52 (x1)
Sure SM 81 (x4)
EV ND/468 (x4)
Beyer Dynamic M88 (x1)
Sennheiser 421 (x2)
Direct boxes Klark Teknik DN100 (x6), Whirlwind Hotbox (x1)
Assorted microphone stand and cables

Portable Wireless: Shure Dual channel UR4D:

UR1 Lavalier (x6)

Beta 58 A (x6)

FOH Wireless : Sure UR4D (x4)
Handheld w Beta 58 (x8)
Sony NBX6 6 channel assorted mics

Playback /

Record: Tascam CD-450 (x2)
Tascam CD-RW 900sl (x1)
House Intercom: Clear-Com 4 channel, (12) beltpacks with
Headsets, also 1 4-channel HME RW 800 wireless system

Paging and program available in all dressing rooms and backstage
FOH color, infra-red and conductor video available onstage

Microphone stands: Stick:
K&M Chrome large thread (x5)
Black small thread (x9)

Black large thread (x9)

Tripod:

K&M Small tripod w/boom (x5)

K&M Large tripod with boom (x11)

AKG Tripod w/boom (x1)

Booms:

Boom (x4).

Drum Claw (x4)

Table top (x8)

Bases:

Atlas rounded small stick (3)

Flat small stick (x6)

Small large stick (x3)

Large stick (x4)

Triangle large stick (x8)

Contact: House Audio Engineer, Al Garcia

Work: (860) 987-5941

FILM PROJECTION

Movie Screen: 40' W x 22' H Screen has adjustable top and side masking

Projection

Locations: Projection booth or balcony rail

Projectors: 1 - ____mm projector: Panasonic, (Model____)
____-watt ____ lamps

- Projection booth throw distance to stage from approximately 90'

- Projection balcony rail position throw to stage approximately 65'

DRESSING ROOMS

- There are nine (9) rooms to accommodate approximately 80 performers.
- There is an orchestra assembly room with 52 lockers (32 will be full height) with direct access to orchestra pit.
- All dressing rooms have private toilets and showers.
- There is a "Star" Dressing Room.

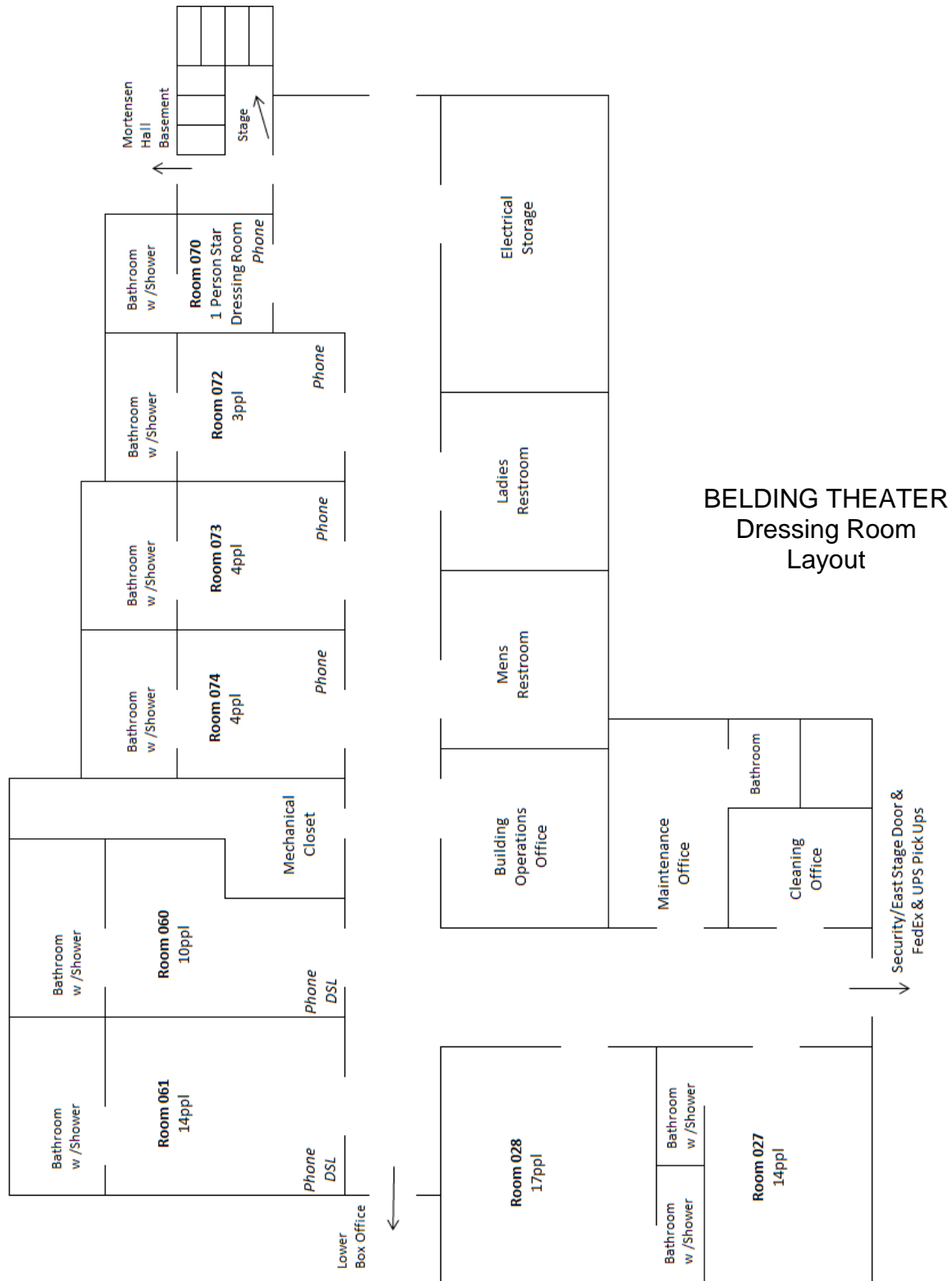

STAGE PLOT

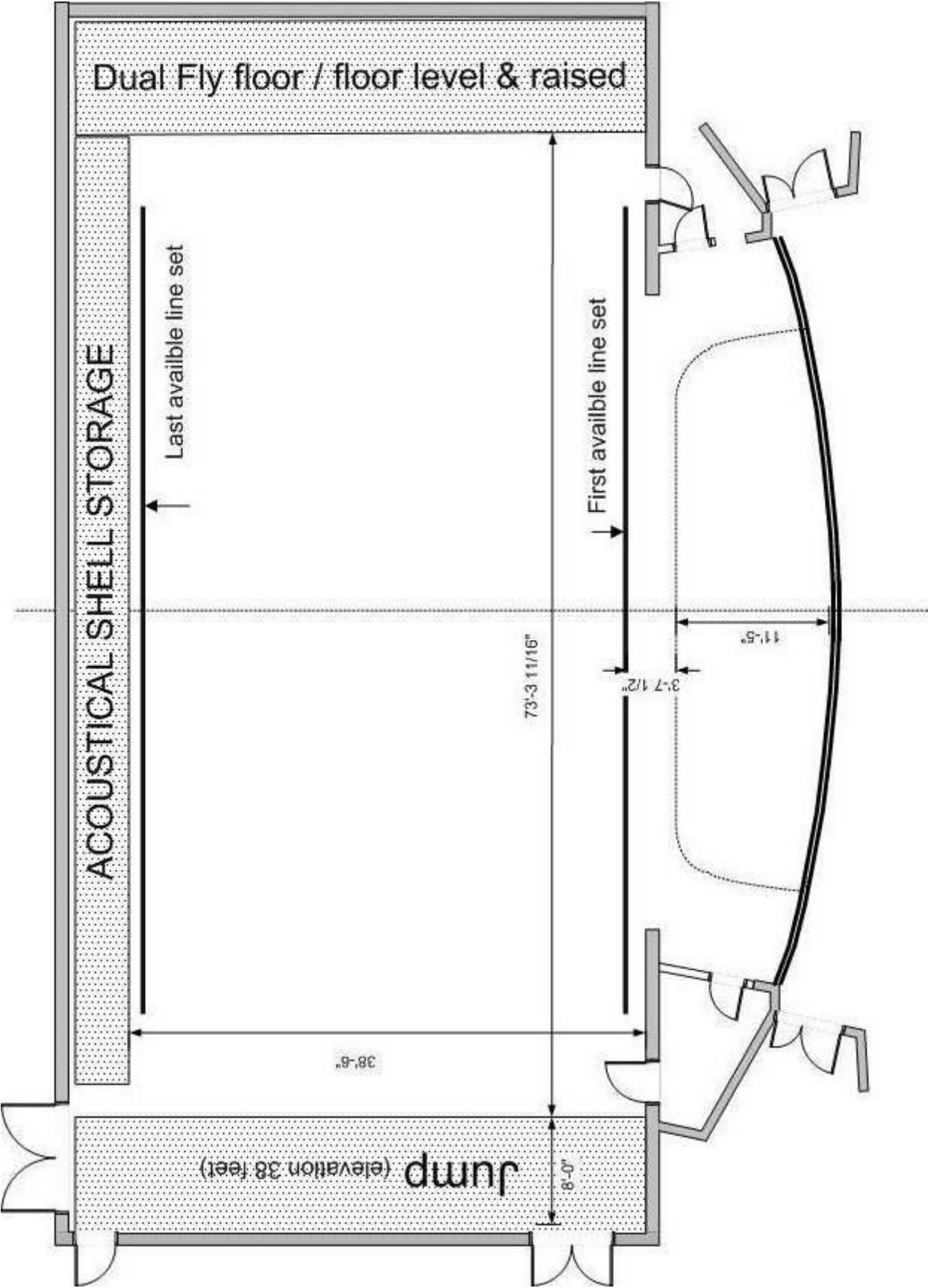

Black Ops

For tie units not shown in true position

6E

5E

4E

3E

2E

1E

100 101 102 103 104 105 106 107 108 109 110 111 112 113 114 115 116 117 118 119 120 121 122 123 124 125 126 127 128 129 130 131 132 133 134 135 136 137 138 139 140 141 142 143 144 145 146 147 148 149 150 151 152 153 154 155 156 157 158 159 160 161 162 163 164 165 166 167 168 169 170 171 172 173 174 175 176 177 178 179 180 181 182 183 184 185 186 187 188 189 190 191 192 193 194 195 196 197 198 199 200 201 202 203 204 205 206 207 208 209 210 211 212 213 214 215 216 217 218 219 220 221 222 223 224 225 226 227 228 229 230 231 232 233 234 235 236 237 238 239 240 241 242 243 244 245 246 247 248 249 250 251 252 253 254 255 256 257 258 259 260 261 262 263 264 265 266 267 268 269 270 271 272 273 274 275 276 277 278 279 280 281 282 283 284 285 286 287 288 289 290 291 292 293 294 295 296 297 298 299 300 301 302 303 304 305 306 307 308 309 310 311 312 313 314 315 316 317 318 319 320 321 322 323 324 325 326 327 328 329 330 331 332 333 334 335 336 337 338 339 340 341 342 343 344 345 346 347 348 349 350 351 352 353 354 355 356 357 358 359 360 361 362 363 364 365 366 367 368 369 370 371 372 373 374 375 376 377 378 379 380 381 382 383 384 385 386 387 388 389 390 391 392 393 394 395 396 397 398 399 400 401 402 403 404 405 406 407 408 409 410 411 412 413 414 415 416 417 418 419 420 421 422 423 424 425 426 427 428 429 430 431 432 433 434 435 436 437 438 439 440 441 442 443 444 445 446 447 448 449 450 451 452 453 454 455 456 457 458 459 460 461 462 463 464 465 466 467 468 469 470 471 472 473 474 475 476 477 478 479 480 481 482 483 484 485 486 487 488 489 490 491 492 493 494 495 496 497 498 499 500 501 502 503 504 505 506 507 508 509 510 511 512 513 514 515 516 517 518 519 520 521 522 523 524 525 526 527 528 529 530 531 532 533 534 535 536 537 538 539 540 541 542 543 544 545 546 547 548 549 550 551 552 553 554 555 556 557 558 559 560 561 562 563 564 565 566 567 568 569 570 571 572 573 574 575 576 577 578 579 580 581 582 583 584 585 586 587 588 589 590 591 592 593 594 595 596 597 598 599 600 601 602 603 604 605 606 607 608 609 610 611 612 613 614 615 616 617 618 619 620 621 622 623 624 625 626 627 628 629 630 631 632 633 634 635 636 637 638 639 640 641 642 643 644 645 646 647 648 649 650 651 652 653 654 655 656 657 658 659 660 661 662 663 664 665 666 667 668 669 670 671 672 673 674 675 676 677 678 679 680 681 682 683 684 685 686 687 688 689 690 691 692 693 694 695 696 697 698 699 700 701 702 703 704 705 706 707 708 709 710 711 712 713 714 715 716 717 718 719 720 721 722 723 724 725 726 727 728 729 730 731 732 733 734 735 736 737 738 739 740 741 742 743 744 745 746 747 748 749 750 751 752 753 754 755 756 757 758 759 760 761 762 763 764 765 766 767 768 769 770 771 772 773 774 775 776 777 778 779 780 781 782 783 784 785 786 787 788 789 790 791 792 793 794 795 796 797 798 799 800 801 802 803 804 805 806 807 808 809 810 811 812 813 814 815 816 817 818 819 820 821 822 823 824 825 826 827 828 829 830 831 832 833 834 835 836 837 838 839 840 841 842 843 844 845 846 847 848 849 850 851 852 853 854 855 856 857 858 859 860 861 862 863 864 865 866 867 868 869 870 871 872 873 874 875 876 877 878 879 880 881 882 883 884 885 886 887 888 889 890 891 892 893 894 895 896 897 898 899 900 901 902 903 904 905 906 907 908 909 910 911 912 913 914 915 916 917 918 919 920 921 922 923 924 925 926 927 928 929 930 931 932 933 934 935 936 937 938 939 940 941 942 943 944 945 946 947 948 949 950 951 952 953 954 955 956 957 958 959 960 961 962 963 964 965 966 967 968 969 970 971 972 973 974 975 976 977 978 979 980 981 982 983 984 985 986 987 988 989 990 991 992 993 994 995 996 997 998 999 1000

100 101 102 103 104 105 106 107 108 109 110 111 112 113 114 115 116 117 118 119 120 121 122 123 124 125 126 127 128 129 130 131 132 133 134 135 136 137 138 139 140 141 142 143 144 145 146 147 148 149 150 151 152 153 154 155 156 157 158 159 160 161 162 163 164 165 166 167 168 169 170 171 172 173 174 175 176 177 178 179 180 181 182 183 184 185 186 187 188 189 190 191 192 193 194 195 196 197 198 199 200 201 202 203 204

LINE SCHEDULE

HOUSE LINE SET	SHOW LINE SET	DISTANCE FROM 0'- 0"	DESCRIPTION	WEIGHT	NOTES
H/C		1'-3"	HOUSE CURTAIN		36'H x51'H Guillotine with ceter split
1		1'-9"	# 1 house black border		
2		2'-3"	# 1 house black leg		
open					<i>hem set can be installed</i>
3*		3'-3"	HOUSE # 1 ELEC		
4		3'-9"			
5		4'-3"			
open					
open					
7		5'-9"	Symphony shell 43'-6"W x12'H x1'- 2"D		<i>automated line set</i>
open					
open					
9		7'-3"			
10		7'-9"			
11		8'-3"	# 2 house black border		
12		8'-9"	# 2 house black legs		
13		9'-3"			
14		9'-9"	HOUSE # 2 ELEC		
open					<i>hem set can be installed</i>
15*		10'-9"	Screen border		
16		11'-3"			
17		11'-9"	Black Traveler		
18		12'-3"	house projection screen		
19		12'-9"			
20		13'-3"			
21		13'-9"	# 3 house black border		
22		14'-3"	# 3 house black legs		
23		14'-9"			
24		15'-3"	HOUSE # 3 ELEC		
open					<i>hem set can be installed</i>
26*		16'-3"			
open					
open					
28		17'-9"	Symphony shell 38"W x12'H x1'-2"D		<i>automated line set</i>
open					
open					
30		19'-3"	# 4 house black border		
31		19'-9"	# 4 house black legs		
32		20'-3"			
33*		20'-3"	HOUSE # 4 ELEC		

open					<i>hemp set can be installed</i>
34		21'-9"			
35		22'-3"	House Mid Stage Black Drop		
36		22'-9"			
37		23'-3"			
38*		23'-9"			
39		24'-3"			
open					<i>hemp set can be installed</i>
41		25'-3"	# 5 house black border		
42*		25'-9"	# 5 house black legs		
open					<i>hemp set can be installed</i>
44		26'-9"	HOUSE # 5 ELEC		
45		27'-3"			
46		27'-9"			
47		28'-3"			
48		28'-9"			
49*		29'-3"			
open					
51		30'-3"			
open					<i>hemp set can be installed</i>
53		31'-3"	# 6 house black border		
54		31'-9"	# 6 house black legs		
open					<i>hemp set can be installed</i>
55*		32'-9"	house black scrim		
open					<i>hemp set can be installed</i>
57		33'-9"	FAR CYC LX		
58		34'-3"			
59		34'-9"			
60		35'-3"			
61		35'-9"			
62		36'-3"	house white cyclorama		
63		36'-9"	house black drop		
64*		37'-3"			
65		37'-9"			
66		38'-3"			
67		38'-9"			

NOTE:

- 1 .
- 2 . **0'-0" MEASUREMENT IS TAKEN FROM PLASTER LINE @ SMOKE POCKET**
- 3 . Single spot lines and sheaves are available.
- 4 . The counter weight system is single purchase with 75,000 lbs. of available counterweight.
- 5 . Arbor capacity's are all 2000 lbs at pipe end.
- 6 . Length of system pipe 60'-0" and all schedule # 80 pipe.
Truss battens are noted by * and are schedule # 40 pipe.

BELDING THEATER

THE BUSHNELL CENTER
FOR THE PERFORMING ARTS

