

BELDING THEATER

166 Capitol Avenue

Hartford, CT 06106

The Bushnell Box Office:

Phone (860) 987-5900

Administrative Offices:

Phone (860) 987-6000

Fax (860) 987-6070

CONTACT INFORMATION

THEATRICALS / BOOKING

Ric Waldman

V.P. of Programming & Marketing

Phone: (860) 987- 6085

Fax: (860) 987-6070

E-mail: rwaldman@bushnell.org

PROGRAMMING / RENTALS

Tom Sessa

Director, Programs

Phone: (860) 987-6039

Fax: (860) 987-6070

E-mail: tsessa@bushnell.org

Amie Lugo

Programs Assistant

Phone: (860) 987-6056

Fax: (860) 987-6070

E-mail: alugo@bushnell.org

FRONT OF HOUSE / MERCHANDISE

Catherine Gruszka

Assistant Manager, Front of House

Phone: (860) 987-6033

Fax: (860) 987-6070

Email: cgruszka@bushnell.org

FACILITY SALES & SERVICE

Charlie Myers

Director of Facility Sales & Service

Phone: (860) 987-6024

Fax: (860) 987-6070

E-mail: cmyers@bushnell.org

PRODUCTION

Michael J. Sivo

Technical Director

Phone: (860) 987-6063

Fax: (860) 728-0500

Cell: (860) 819-1347

E-mail: msivo@bushnell.org

Dani O'Callahan

Production Coordinator

Phone: (860) 987-6057

Fax: (860) 987-6070

E-mail: docallahan@bushnell.org

BOX OFFICE

Brandon Baker

Associate Director, Box Office

Direct Phone: (860) 987-6054

Fax: (860) 987-6080

E-mail: bbaker@bushnell.org

MARKETING & PROMOTION

Alex Page-Hatley

Associate Director, Marketing

Phone: (860) 987-6082

Fax: (860) 987-6070

E-mail:

apagehatley@bushnell.org

Paul Marte

Communications Manager

Phone: (860) 987-6068

Fax: (860) 987-6070

E-Mail: pmarte@bushnell.org

THE BUSHNELL CENTER FOR THE PERFORMING ARTS

Belding Theater

The interior of the 908-seat Belding Theater is intimate and luxurious, with a decorative painted ceiling, generous use of wood and rich colors and textures. No seat in the theater is more than 75 feet from the stage. Above the orchestra level is a mezzanine that includes private box seating.

THEATER CAPACITY

Total: 908

Orchestra:	617 (deduct 51 seats if orchestra uses Pit)
Accessible/Wheelchair:	6
Sensory Impaired:	6 (Held in the 1 st two center rows)
Companion Seating:	22
Mezzanine:	245 (including 2 Private Boxes, 6 seats each)
Accessible/Wheelchair:	4
Companion Seating:	8

STAGE

Proscenium:	Width 47', height 33'
Deck:	Phenelex (industrial masonite), flat, 2'-11" above orchestra floor. Black in color
Specifications:	Centerline to off stage right wall 46' (not stage left); SR clear fly space 37' Centerline to off stage-left locking rail 42'; SL clear fly space 37' Stage depth 42': taken from proscenium to upstage wall Floor to grid 70' - uniform load of 50lbs per square foot Pipe run 63'-2" Single purchase counterweight system with 75,000lbs available 55 undedicated line-sets, spaced @ 6" o/c, with 6 lines each 2 dedicated motorized line sets for acoustical shell 14' arbors, 2000lb capacity

30 additional sheaves and rope available for single line spotting
 Dual locking rail stage left deck and raised fly-floor @ 33' Pin-rail
 raised stage right @ 33' with upstage crossover to fly-floor. Apron
 edge to proscenium 3'-6"

Pit Elevator: At stage level pit extends 10'-9" at center of crescent-shaped apron
 At auditorium level it will accommodate 51 seats
 At orchestra pit level it will accommodate approx. 40-60 musicians

Travel range is from stage level down 2'-11" to orchestra level, from
 stage level down 9' to pit level, from stage level down 14'-9" to
 basement and trap area

Elevator: 1 backstage, 12' x 10'-10"

Loading Doors: At loading docks 2 @ 8'-4" w x 10' h inside dimension

Stage Door: 8' w x 20' H upstage right corner at loading dock

Loading Docks: (2) Access from Clinton Street (east side) will accommodate 53' trailer

Ramp: There is a ramp that runs parallel to the loading dock for musicians
 who have larger instruments to have direct access to the stage.

Draperies: Front valence and grand drape

7 sets black velour legs (flat)	30'H x 12'W
6 black velour borders (flat)	12'H x 60'W
10 black velour tabs (flat)	30'H x 8'W
2 black velour bi-part traveler	30'H x 60'W
1 Muslin Cyclorama	30'H x 60'W
1 Sharkstooth scrim (black)	30'H x 60'W
1 Sharkstooth scrim (white)	30'H x 60'W

Risers:	24 – 32"x 8'x 8"	4 – 4'x 8'x 8"
	20 – 32"x 8'x 16"	4 – 4' x 8'x 16"

14 – 32"x 8'x 24"

25 – 4'x 8'x 24"

15 – 4' x 8' x 32"

1 each 4'x 4'x (8"),(16"),(24")

Concert Shell: Approximately 1000 square feet, can accommodate approximately 75 musicians

Music Stands/

Chairs: 75 music with clip lights, 100 symphony type chairs
additional folding chairs available.

Pianos: 1 - 9' Steinway D
1 – Yamaha C5SE 6'7"
2 – Yamaha U1SE 48" Upright

STAGEHANDS

IATSE, Local 84

Mike Sullivan Jr, Business Agent

Office: (860) 233-8821, Fax: (860) 233-8827

Minimum call: 3-man crew (Carpenter, Props, Electrician)

4 hours load in, performance, 4 hours load out

LIGHTING

Service: (1) 100 amp 3-phase disconnect located downstage left
(1) 100 amp 3-phase disconnect located downstage right
(2) 400 amp 3-phase disconnect located stage right wall
(1) 400 amp + (1) (200 amp clean) 3-phase disconnect in loading dock area

Circuits:

FOH (all stage pin connectors)

Projection booth (1) 20amp
Far catwalk (12) 20 amp circuits
Near catwalk (12) 20 amp circuits
Far box boom S/L (12) 20 amp circuits + (1) 50 amp circuit
Near box boom S/L (12) 20 amp circuits
Far box boom S/R (12) 20 amp circuits + (1) 50 amp circuit
Near box boom S/R (12) 20 amp circuits
Balcony rail (12) 20 amp circuits + (1) 50 amp circuits

STAGE (all stage pin connectors)

Overhead drops + fixed wall boxes (198) 20 amp circuits + (3) 50 Amp circuits
Trap room (3) 20 amp circuits

FOH Units:

(12) Source Four 10 degree
(48) Source Four 19 degree
(24) Source Four 26 degree

Additional Units Inventory:

(2) Source Four 10 degree
(12) Source Four 19 degree
(38) Source Four 26 degree
(36) Source Four 36 degree
(6) Source Four 50 degree
(48) Par 64 1
(7) Far Cyc 3-circuit

Dimmers: ETC SENSOR- dimmer per circuit (276) 2.4k + (6) 5k dimmers

Light Board: ETC ION 3072 (including Ethernet network to all positions)

Follow-spots: (2) Lycian Super Stars 1200 watt HMI
Concert Lighting: (2) banks each of (5) par 56 units, incorporated in each of two onstage overhead ceilings and 1 ceiling FOH

Contact: Head Electrician, Joe Gates (860) 987-5942

SOUND

The Bushnell Front of House Sound System is in excellent condition including a high quality PA capable of reproducing music clearly and without distortion at 115db at the mixing position and with even coverage throughout the full audience areas.

Main Console: Avid Venue Profile w/ 2-48 channel digital stage boxes

Power Service: (1) 100 amp 3-phase located downstage left
(1) 60 amp breakout located downstage left
(1) 60 amp breakout located downstage right
(1) 100 amp 3-phase located upstage right wall

House PA: Center Cluster D&B 10 AD (x6)
S/R Proscenium: D&B C7 (x3), C7 sub (x1), B2 sub (x1)
S/L Proscenium: D&B C7 (x3), C7 sub (x1), B2 sub (x1)
Front fill: D&B 8S (x4)
Under balcony: (8) EAW JF80T60
Amplifiers: D&B D12 (x7), QSC 1202 (x4)

Monitors: EAW SM200IH (x6)
EAW JF200E (x4)
EAW JF260Z (x2)

EAW JF80 (x2)

Microphones:

- Sure SM 58 (x9)
- Sure SM 51 (x5)
- Sure BETA SM 52 (x1)
- Sure SM 81 (x4)
- EV ND/468 (x4)
- Beyer Dynamic M88 (x1)
- Sennheiser 421 (x2)
- Direct boxes Klark Teknik DN100 (x6), Whirlwind Hotbox (x1)
- Assorted microphone stand and cables

Portable Wireless: Shure Dual channel UR4D:
UR1 Lavalier (x6)
Beta 58 A (x6)

FOH Wireless : Sure UR4D (x4)
Handheld w Beta 58 (x8)
Sony NBX6 6 channell assorted mics

Playback /

Record: Tascam CD-450 (x2)
Tascam CD-RW 900sl (x1)
House Intercom: Clear-Com 4 channel, (12) beltpacks with
Headsets, also 1 4-channel HME RW 800 wireless system

Paging and program available in all dressing rooms and backstage
FOH color, infra-red and conductor video available onstage

Microphone stands:

Stick:
K&M Chrome large thread (x5)
Black small thread (x9)

Black large thread (x9)

Tripod:

K&M Small tripod w/boom (x5)

K&M Large tripod with boom (x11)

AKG Tripod w/boom (x1)

Booms:

Boom (x4).

Drum Claw (x4)

Table top (x8)

Bases:

Atlas rounded small stick (3)

Flat small stick (x6)

Small large stick (x3)

Large stick (x4)

Triangle large stick (x8)

Contact: House Audio Engineer, Al Garcia

Work: (860) 987-5941

FILM PROJECTION

Movie Screen: 40' W x 22' H Screen has adjustable top and side masking

Projection

Locations: Projection booth or balcony rail

Projectors: 1 - ____mm projector: Panasonic, (Model____)
_____-watt _____ lamps

- Projection booth throw distance to stage from approximately 90'

- Projection balcony rail position throw to stage approximately 65'

DRESSING ROOMS

- There are nine (9) rooms to accommodate approximately 80 performers.
- There is an orchestra assembly room with 52 lockers (32 will be full height) with direct access to orchestra pit.
- All dressing rooms have private toilets and showers.
- There is a "Star" Dressing Room.

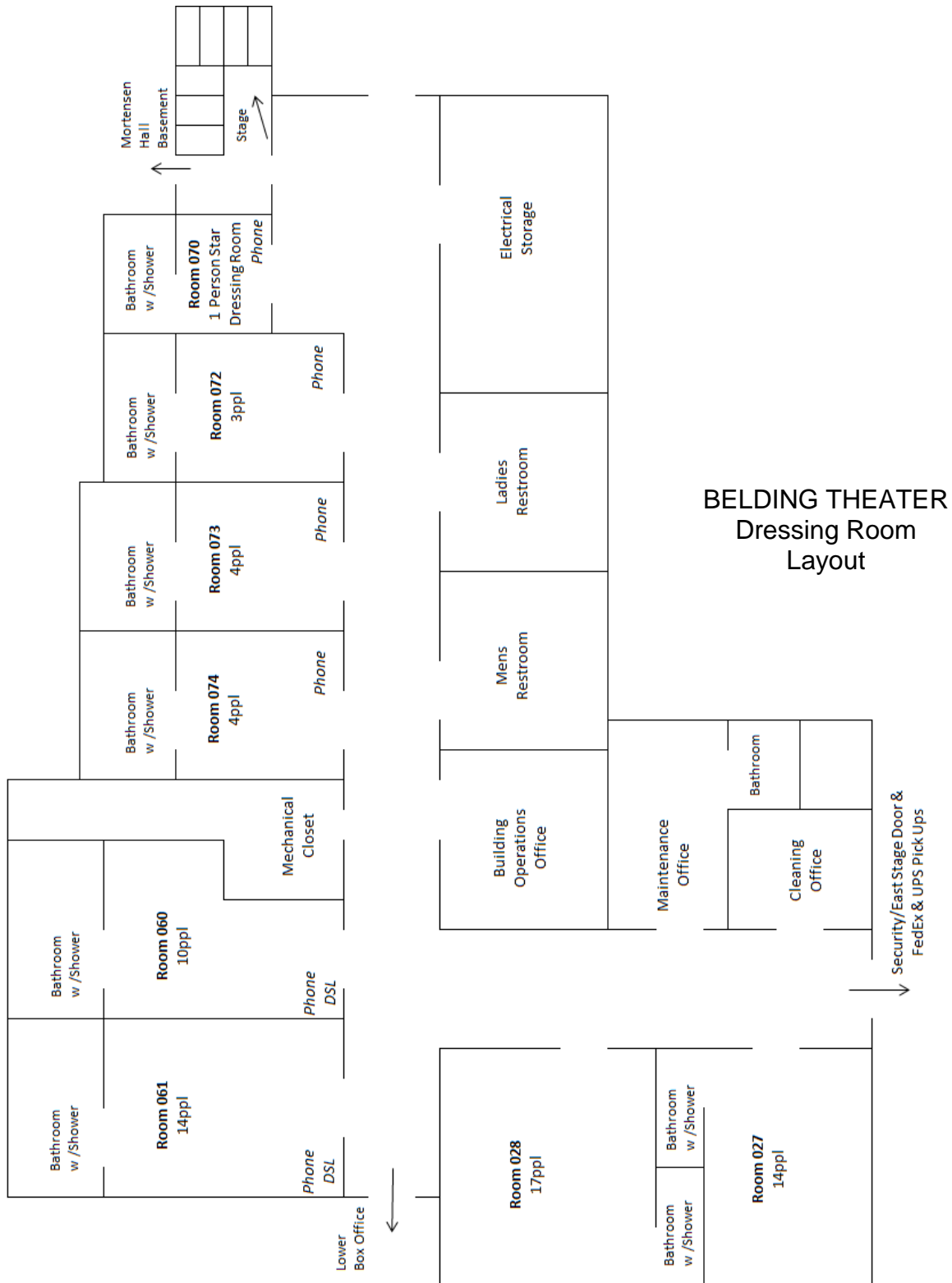

STAGE PLOT

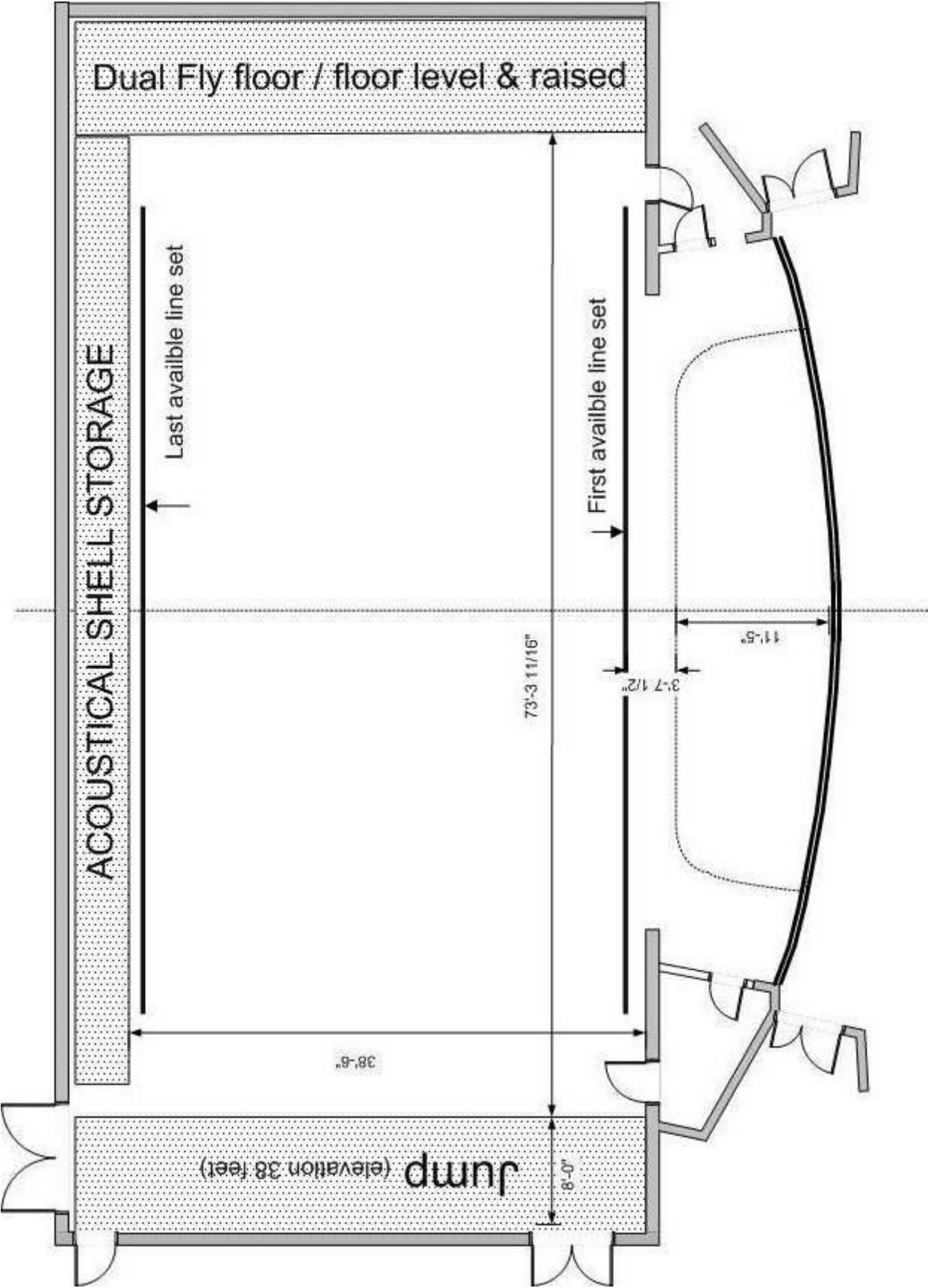

Black Ops

For top units not shown in true position:
A1 A2 A3 A4 A5 A6 A7 A8 A9 A10 A11 A12 A13 A14 A15 A16 A17 A18 A19 A20 A21 A22 A23 A24 A25 A26 A27 A28 A29 A30 A31 A32 A33 A34 A35 A36 A37 A38 A39 A40 A41 A42 A43 A44 A45 A46 A47 A48 A49 A50 A51 A52 A53 A54 A55 A56 A57 A58 A59 A60 A61 A62 A63 A64 A65 A66 A67 A68 A69 A70 A71 A72 A73 A74 A75 A76 A77 A78 A79 A80 A81 A82 A83 A84 A85 A86 A87 A88 A89 A90 A91 A92 A93 A94 A95 A96 A97 A98 A99 A100 A101 A102 A103 A104 A105 A106 A107 A108 A109 A110 A111 A112 A113 A114 A115 A116 A117 A118 A119 A120 A121 A122 A123 A124 A125 A126 A127 A128 A129 A130 A131 A132 A133 A134 A135 A136 A137 A138 A139 A140 A141 A142 A143 A144 A145 A146 A147 A148 A149 A150 A151 A152 A153 A154 A155 A156 A157 A158 A159 A160 A161 A162 A163 A164 A165 A166 A167 A168 A169 A170 A171 A172 A173 A174 A175 A176 A177 A178 A179 A180 A181 A182 A183 A184 A185 A186 A187 A188 A189 A190 A191 A192 A193 A194 A195 A196 A197 A198 A199 A200 A201 A202 A203 A204 A205 A206 A207 A208 A209 A210 A211 A212 A213 A214 A215 A216 A217 A218 A219 A220 A221 A222 A223 A224 A225 A226 A227 A228 A229 A230 A231 A232 A233 A234 A235 A236 A237 A238 A239 A240 A241 A242 A243 A244 A245 A246 A247 A248 A249 A250 A251 A252 A253 A254 A255 A256 A257 A258 A259 A260 A261 A262 A263 A264 A265 A266 A267 A268 A269 A270 A271 A272 A273 A274 A275 A276 A277 A278 A279 A280 A281 A282 A283 A284 A285 A286 A287 A288 A289 A290 A291 A292 A293 A294 A295 A296 A297 A298 A299 A300 A301 A302 A303 A304 A305 A306 A307 A308 A309 A310 A311 A312 A313 A314 A315 A316 A317 A318 A319 A320 A321 A322 A323 A324 A325 A326 A327 A328 A329 A330 A331 A332 A333 A334 A335 A336 A337 A338 A339 A340 A341 A342 A343 A344 A345 A346 A347 A348 A349 A350 A351 A352 A353 A354 A355 A356 A357 A358 A359 A360 A361 A362 A363 A364 A365 A366 A367 A368 A369 A370 A371 A372 A373 A374 A375 A376 A377 A378 A379 A380 A381 A382 A383 A384 A385 A386 A387 A388 A389 A390 A391 A392 A393 A394 A395 A396 A397 A398 A399 A400 A401 A402 A403 A404 A405 A406 A407 A408 A409 A410 A411 A412 A413 A414 A415 A416 A417 A418 A419 A420 A421 A422 A423 A424 A425 A426 A427 A428 A429 A430 A431 A432 A433 A434 A435 A436 A437 A438 A439 A440 A441 A442 A443 A444 A445 A446 A447 A448 A449 A450 A451 A452 A453 A454 A455 A456 A457 A458 A459 A460 A461 A462 A463 A464 A465 A466 A467 A468 A469 A470 A471 A472 A473 A474 A475 A476 A477 A478 A479 A480 A481 A482 A483 A484 A485 A486 A487 A488 A489 A490 A491 A492 A493 A494 A495 A496 A497 A498 A499 A500 A501 A502 A503 A504 A505 A506 A507 A508 A509 A510 A511 A512 A513 A514 A515 A516 A517 A518 A519 A520 A521 A522 A523 A524 A525 A526 A527 A528 A529 A530 A531 A532 A533 A534 A535 A536 A537 A538 A539 A540 A541 A542 A543 A544 A545 A546 A547 A548 A549 A550 A551 A552 A553 A554 A555 A556 A557 A558 A559 A560 A561 A562 A563 A564 A565 A566 A567 A568 A569 A570 A571 A572 A573 A574 A575 A576 A577 A578 A579 A580 A581 A582 A583 A584 A585 A586 A587 A588 A589 A590 A591 A592 A593 A594 A595 A596 A597 A598 A599 A600 A601 A602 A603 A604 A605 A606 A607 A608 A609 A610 A611 A612 A613 A614 A615 A616 A617 A618 A619 A620 A621 A622 A623 A624 A625 A626 A627 A628 A629 A630 A631 A632 A633 A634 A635 A636 A637 A638 A639 A640 A641 A642 A643 A644 A645 A646 A647 A648 A649 A650 A651 A652 A653 A654 A655 A656 A657 A658 A659 A660 A661 A662 A663 A664 A665 A666 A667 A668 A669 A670 A671 A672 A673 A674 A675 A676 A677 A678 A679 A680 A681 A682 A683 A684 A685 A686 A687 A688 A689 A690 A691 A692 A693 A694 A695 A696 A697 A698 A699 A700 A701 A702 A703 A704 A705 A706 A707 A708 A709 A710 A711 A712 A713 A714 A715 A716 A717 A718 A719 A720 A721 A722 A723 A724 A725 A726 A727 A728 A729 A730 A731 A732 A733 A734 A735 A736 A737 A738 A739 A740 A741 A742 A743 A744 A745 A746 A747 A748 A749 A750 A751 A752 A753 A754 A755 A756 A757 A758 A759 A760 A761 A762 A763 A764 A765 A766 A767 A768 A769 A770 A771 A772 A773 A774 A775 A776 A777 A778 A779 A780 A781 A782 A783 A784 A785 A786 A787 A788 A789 A790 A791 A792 A793 A794 A795 A796 A797 A798 A799 A800 A801 A802 A803 A804 A805 A806 A807 A808 A809 A810 A811 A812 A813 A814 A815 A816 A817 A818 A819 A820 A821 A822 A823 A824 A825 A826 A827 A828 A829 A830 A831 A832 A833 A834 A835 A836 A837 A838 A839 A840 A841 A842 A843 A844 A845 A846 A847 A848 A849 A850 A851 A852 A853 A854 A855 A856 A857 A858 A859 A860 A861 A862 A863 A864 A865 A866 A867 A868 A869 A870 A871 A872 A873 A874 A875 A876 A877 A878 A879 A880 A881 A882 A883 A884 A885 A886 A887 A888 A889 A890 A891 A892 A893 A894 A895 A896 A897 A898 A899 A900 A901 A902 A903 A904 A905 A906 A907 A908 A909 A910 A911 A912 A913 A914 A915 A916 A917 A918 A919 A920 A921 A922 A923 A924 A925 A926 A927 A928 A929 A930 A931 A932 A933 A934 A935 A936 A937 A938 A939 A940 A941 A942 A943 A944 A945 A946 A947 A948 A949 A950 A951 A952 A953 A954 A955 A956 A957 A958 A959 A960 A961 A962 A963 A964 A965 A966 A967 A968 A969 A970 A971 A972 A973 A974 A975 A976 A977 A978 A979 A980 A981 A982 A983 A984 A985 A986 A987 A988 A989 A990 A991 A992 A993 A994 A995 A996 A997 A998 A999 A1000 A1001 A1002 A1003 A1004 A1005 A1006 A1007 A1008 A1009 A1010 A1011 A1012 A1013 A1014 A1015 A1016 A1017 A1018 A1019 A1020 A1021 A1022 A1023 A1024 A1025 A1026 A1027 A1028 A1029 A1030 A1031 A1032 A1033 A1034 A1035 A103

LINE SCHEDULE

HOUSE LINE SET	SHOW LINE SET	DISTANCE FROM 0'- 0"	DESCRIPTION	WEIGHT	NOTES
H/C		1'-3"	HOUSE CURTAIN		36'H x51'H Guillotine with ceter split
1		1'-9"	# 1 house black border		
2		2'-3"	# 1 house black leg		
open					<i>hem set can be installed</i>
3*		3'-3"	HOUSE # 1 ELEC		
4		3'-9"			
5		4'-3"			
open					
open					
7		5'-9"	Symphony shell 43'-6"W x12'H x1'- 2"D		<i>automated line set</i>
open					
open					
9		7'-3"			
10		7'-9"			
11		8'-3"	# 2 house black border		
12		8'-9"	# 2 house black legs		
13		9'-3"			
14		9'-9"	HOUSE # 2 ELEC		
open					<i>hem set can be installed</i>
15*		10'-9"	Screen border		
16		11'-3"			
17		11'-9"	Black Traveler		
18		12'-3"	house projection screen		
19		12'-9"			
20		13'-3"			
21		13'-9"	# 3 house black border		
22		14'-3"	# 3 house black legs		
23		14'-9"			
24		15'-3"	HOUSE # 3 ELEC		
open					<i>hem set can be installed</i>
26*		16'-3"			
open					
open					
28		17'-9"	Symphony shell 38"W x12'H x1'-2"D		<i>automated line set</i>
open					
open					
30		19'-3"	# 4 house black border		
31		19'-9"	# 4 house black legs		
32		20'-3"			
33*		20'-3"	HOUSE # 4 ELEC		

open					<i>hemp set can be installed</i>
34		21'-9"			
35		22'-3"	House Mid Stage Black Drop		
36		22'-9"			
37		23'-3"			
38*		23'-9"			
39		24'-3"			
open					<i>hemp set can be installed</i>
41		25'-3"	# 5 house black border		
42*		25'-9"	# 5 house black legs		
open					<i>hemp set can be installed</i>
44		26'-9"	HOUSE # 5 ELEC		
45		27'-3"			
46		27'-9"			
47		28'-3"			
48		28'-9"			
49*		29'-3"			
open					
51		30'-3"			
open					<i>hemp set can be installed</i>
53		31'-3"	# 6 house black border		
54		31'-9"	# 6 house black legs		
open					<i>hemp set can be installed</i>
55*		32'-9"	house black scrim		
open					<i>hemp set can be installed</i>
57		33'-9"	FAR CYC LX		
58		34'-3"			
59		34'-9"			
60		35'-3"			
61		35'-9"			
62		36'-3"	house white cyclorama		
63		36'-9"	house black drop		
64*		37'-3"			
65		37'-9"			
66		38'-3"			
67		38'-9"			

NOTE:

- 1 .
- 2 . **0'-0" MEASUREMENT IS TAKEN FROM PLASTER LINE @ SMOKE POCKET**
- 3 . Single spot lines and sheaves are available.
- 4 . The counter weight system is single purchase with 75,000 lbs. of available counterweight.
- 5 . Arbor capacity's are all 2000 lbs at pipe end.
- 6 . Length of system pipe 60'-0" and all schedule # 80 pipe.
Truss battens are noted by * and are schedule # 40 pipe.

BELDING THEATER

THE BUSHNELL CENTER
FOR THE PERFORMING ARTS

